

# Forest Hill School

“Together as One”



Self-Directed  
Auto-Dirijido



Innovative  
Innovador



Critical Thinker  
Pensador Critico



Collaborative  
Colaborativo



Empathetic  
Empático

## All Students on Site

May 3<sup>rd</sup>, 2021

Information for Parents and Students

### School Schedule (Changed)

Forest Hill's Bell Schedule Starting May 3rd, 2021					
Mondays, Tuesdays, Thursdays, & Fridays			Wednesdays		
Grade Levels	Start Time	End Time	Grade Levels	Start Time	End Time
K-3	8:10	2:10	K-3	8:10	11:45
4-5	8:20	2:20	4-5	8:20	12:00
All SDC	8:30	2:30	All SDC	8:30	12:10
Staggered Recesses (20 minutes for all)	9:30	10:55	Staggered Recesses (20 minutes for all)	9:30	10:55
Staggered lunches (35 minutes for all)	11:00	1:20	No lunch will be served at school on Wednesdays Free Grab and Go lunches will be available		

### Drop Off and Pick-up Procedures

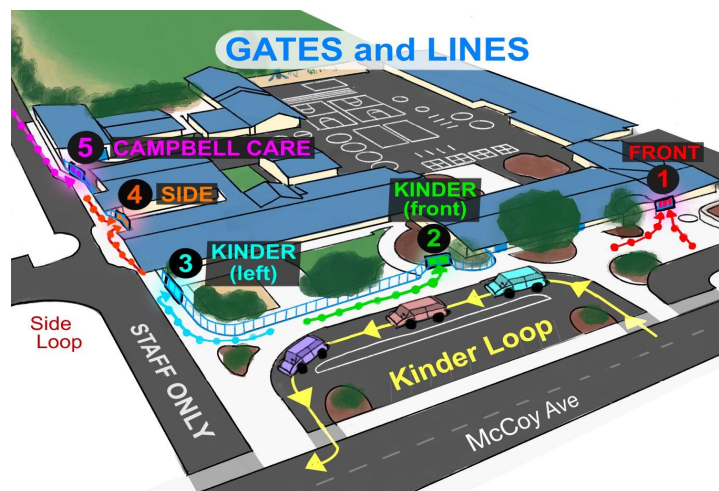

## Kindergarten: 8:10-2:10 (Pick-up time changed)

**Drop Off** Instruction will start at 8:10 AM. Students can start lining up just outside the gate between 8:00-8:07. Mrs. Hannan and Mrs. Cittadino's class will use gate 3 (see map above). Mrs. Unsinger and Mrs. Ishimatsu need to line up by gate # 2. Kinder teachers will pick students up from the gate at 8:07 AM.

**Pick Up** 2:10 PM: Gates are assigned by classroom (see map above)

Gate # 2 Kindergarten (Mrs Unsinger, Mrs. Ishimatsu, Ms. Faso & Ms. LaValle)

Gate # 3 Kindergarten (Mrs. Hannan and Mrs Cittadino)

- Cars will enter through the kinder loop in front of the kindergarten playground for Gate #2 and #3 for pick up or drop off from vehicles. Please DO NOT leave cars unattended.
- If you intend to walk your student to the gate, you must park on the streets around Forest Hill. **Only one adult may accompany a student.** Everyone must have a mask on and adhere to the 6 feet distancing.

## First through Third Grades: 8:10 AM-2:10 PM (Pick-up time changed)

**Drop Off** 8:00- 8:07 AM

**Pick Up** 2:10 PM

- Gates #1(front), Gate #4 and #5 (side) (back- students will walk using the path towards Campbell Care)
- Gate 4 will close at 8:10 AM.

## Fourth and Fifth Grades: 8:20-2:20 (Pick-up time and gate changed)

**Drop Off** 8:10 AM

**Pick Up** 2:20 PM

- Gate 1 and 5 (back- students will walk using the path towards Campbell Care)
- Please note that we eliminated gate #4 due to staffing challenges. Gate 4 will close at 8:10 AM.

## Special Day Classes (SDC): 8:30-2:30 (Time changes)

**Drop Off** 8:20 AM

**Pick Up** 2:30 PM

- Use Kinder Loop

LaValle & Summer- Kinder Gate #2

All other SDC - Front Gate #1

## Tardy Procedures: Please do your best to be on time!

If you arrive after your scheduled drop-off time, then you will need to report outside the front office. Students will be formally marked as tardy if they arrive after the scheduled start of the instructional day. (K-3<sup>rd</sup> – 8:10 AM, 4<sup>th</sup>-5<sup>th</sup> – 8:20 AM, and SDC–8:30 AM)

# Lunch

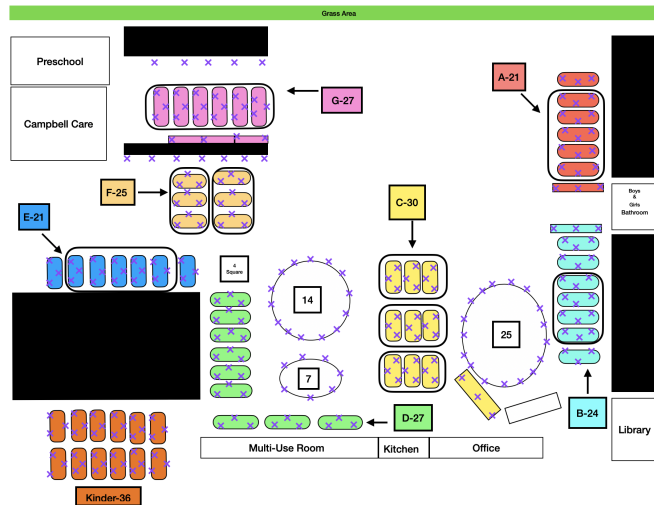

Students will eat lunch outside, spaced 6 feet apart. After eating, they will put their face covering back on and be released to play in their assigned play zone areas.

- Students may bring a lunch from home or eat a school provided lunch. School lunches will continue to be free through the end of the school year.
- On Wednesdays, (early dismissal), students may take a “Grab and Go” lunch
- **To reduce close contact and exposure, please send snacks and lunches that your student can open on his/her own.**

# Health Screening

- Parents or guardians are required to conduct symptom screening at home with your child each day prior to arrival at school. Your signed copy of the COVID-19 Symptom Check agreement acknowledging that you will conduct these daily symptom checks are kept on file in the school office.

